

PYRAMIDE

411



**Collezione di
rubinetteria
monocomando**
con cartuccia a dischi ceramici

**Single-lever tap
collection**
with ceramic disc cartridge

Einhebelmischer
mit Keramikkartusche

**Colección de grifería
monomando**
con cartucho de discos
cerámicos

**Collection de
robinetterie mitigeurs**
avec cartouches à disques
céramique

PYRAMIDE

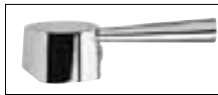

0003000000
0009000000
Leva conica
Conical lever
Konischer Hebel
Palanca cónica
Levier conique



0001000000
0008000000
Leva joystick
Joystick lever
Joystick-Bedienhebel
Palanca joystick
Levier joystick

| | | | |
|---|--|--|--|
| OO Cromo Chrome Chrom Cromo Chromé | | | |
|---|--|--|--|

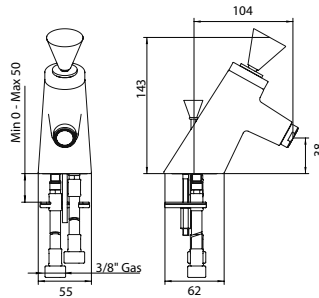

Monocomando lavabo
Single-lever washbasin mixer
Waschtischeinhebelmischer
Monomando lavabo
Mitigeur de lavabo

| art. | €uro | | |
|------------|--------|--|--|
| 9503200000 | 189,00 | | |
| 9501200000 | 207,00 | | |

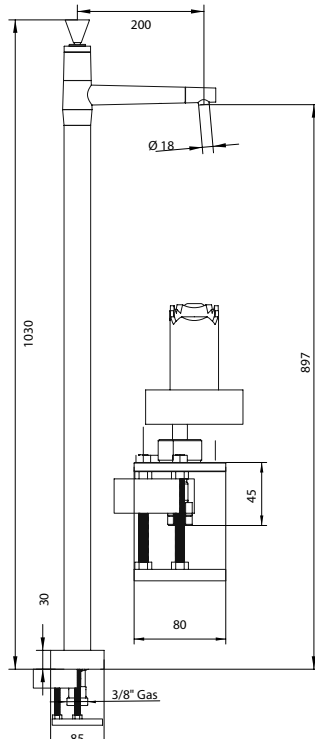
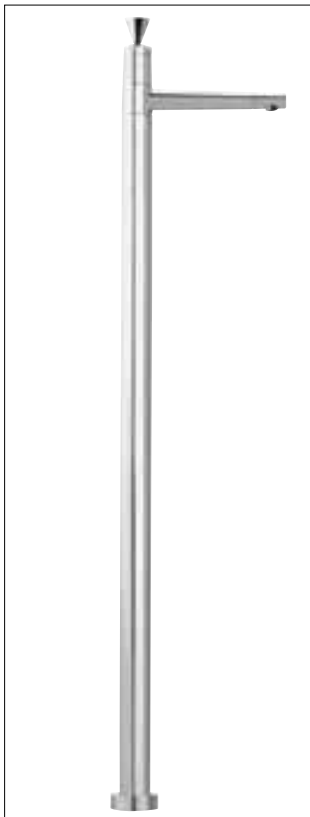
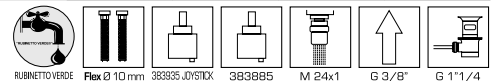

Monocomando lavabo con prolunga da terra e piastra di fissaggio
Single-lever washbasin mixer with ground extension and fixing plate
Einhebelmischer auf Standfuß mit Montagebasisplatte
Monomando lavabo con prolongación, desde pavimento y placa de fijación
Mitigeur pour lavabo avec rallonge de sol et plaque de fixation

| art. | €uro | | |
|------------|--------|--|--|
| 9509200000 | 670,00 | | |
| 9508200000 | 618,00 | | |

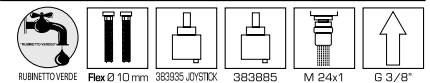

Piastra di fissaggio per lavabo da terra
Floor plate for washbasin tap column
Montagebasisplatte für Armaturenstandfuß
Lamina de fijación para lavabo desde pavimento
Plaque de fixation pour lavabo de sol

| art. | €uro | | |
|------------|-------|--|--|
| 5194200000 | 85,00 | | |

| | | | |
|---|--|--|--|
| OO Cromo Chrome Chrom Cromo Chrome | | | |
|---|--|--|--|



0003000000
0009000000
Leva conica
Conical lever
Konischer Hebel
Palanca cónica
Levier conique



0001000000
0008000000
Leva joystick
Joystick lever
Joystick-Bedienhebel
Palanca joystick
Levier joystick

Monocomando bidet

Single-lever bidet mixer
Bideteinhebelmischer
Monomando bidet
Mitigeur de bidet

| €uro | art. |
|--------|------------|
| 189,00 | 9523200000 |
| 207,00 | 9521200000 |

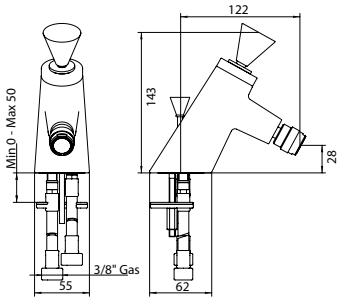
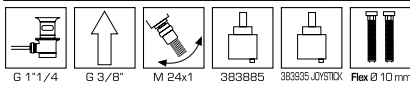

Monocomando vasca esterno completo

Single-lever wall mtd bathtub set
Wanneneinhebelmischer mit Duschgarnitur und Handbrause
Monomando bañera externo completo
Mitigeur de baignoire externe complet

| €uro | art. |
|--------|------------|
| 322,00 | 9553200000 |
| 340,00 | 9551200000 |

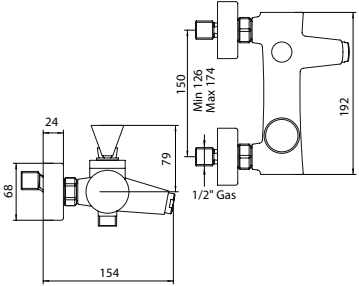
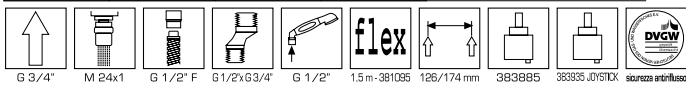

Monocomando vasca esterno senza kit doccia

Single-lever wall mtd bathtub set without shower kit
Wanneneinhebelmischer ohne Duschset
Monomando bañera externo, sin kit de ducha
Mitigeur de baignoire externe sans kit de douche

| €uro | art. |
|--------|------------|
| 232,00 | 95532000SF |
| 250,00 | 95512000SF |

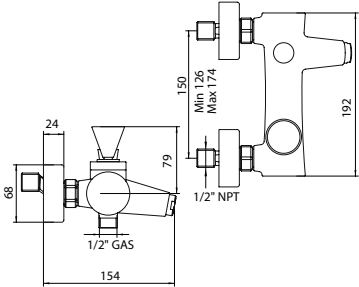
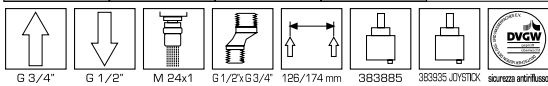

Monocomando doccia incasso

Concealed single-lever shower control
Brauseeinhebelmischer-UP
Monomando ducha, de pared
Mitigeur de douche à encastrer

| €uro | art. |
|--------|------------|
| 164,00 | 9543200000 |
| 189,00 | 9541200000 |

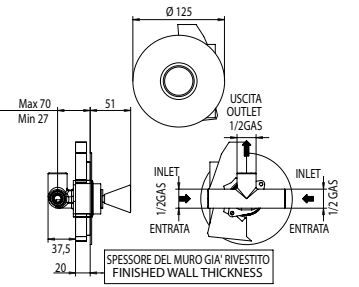
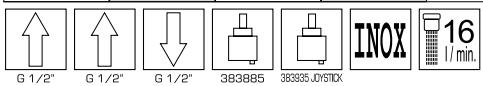

PYRAMIDE

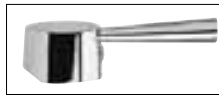

0013000000
0019000000
Leva conica
Conical lever
Konischer Hebel
Palanca cónica
Levier conique



0001000000
0008000000
Leva joystick
Joystick lever
Joystick-Bedienhebel
Palanca joystick
Levier joystick

| | | | | |
|---|--|--|--|--|
| OO Cromo Chrome Chrom Cromo Chromé | | | | |
|---|--|--|--|--|

414



Parte grezza incassata per monocomando incasso doccia

Rough part built-in for concealed single lever shower mixer
UP rohes Teil fur Dusche ehm
Lado basto encajonado para monomando ducha de pared
Partie brute encastree pour mitigeur de douche à encastrer

| art. | €uro | | | |
|--------|-------|--|--|--|
| 386934 | 79,00 | | | |
| | | | | |
| | | | | |

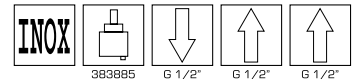

Parte grezza incassata per monocomando incasso doccia

Rough part built-in for concealed single lever shower mixer
UP rohes Teil fur Dusche ehm
Lado basto encajonado para monomando ducha de pared
Partie brute encastree pour mitigeur de douche à encastrer

| art. | €uro | | | |
|--------|-------|--|--|--|
| 387424 | 79,00 | | | |
| | | | | |
| | | | | |

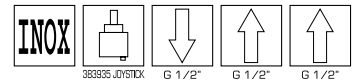

PYRAMIDE



Parte esterna incasso doccia (leva conica)

Outside part of concealed shower (conical lever)
Außen Teil für Dusche (konischer Hebel)
Lado exterior de pared ducha (palanca cónica)
Partie externe pour douche à encastrer (levier conique)

| art. | €uro | | | |
|--------|-------|--|--|--|
| 386994 | 89,00 | | | |
| | | | | |
| | | | | |



Parte esterna incasso doccia (Leva joystick)

Outside part of concealed shower (joystick lever)
Außen Teil für Dusche (Joystick-Bedienhebel)
Lado exterior de pared ducha (palanca joystick)
Partie externe pour douche à encastrer (levier joystick)

| art. | €uro | | | |
|--------|-------|--|--|--|
| 387434 | 94,00 | | | |
| | | | | |
| | | | | |

| | | | |
|---|--|--|--|
| OO Cromo Chrome Chrom Cromo Chrome | | | |
|---|--|--|--|



0003000000
0009000000
Leva conica
Conical lever
Konischer Hebel
Palanca cónica
Lever conique



0001000000
0008000000
Leva joystick
Joystick lever
Joystick-Bedienhebel
Palanca joystick
Lever joystick

Monocomando vasca/doccia incasso

Concealed single-lever bathtub/shower control
Brause und Wanneneinhebelmischer-UP
Monomando bañera/ducha de pared
Mitigeur de baignoire/douche à encastrer

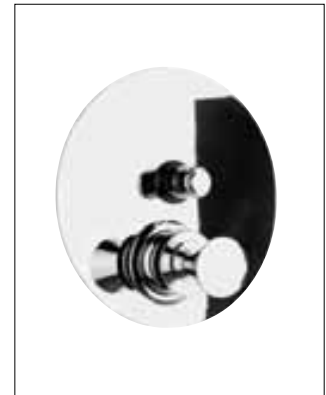
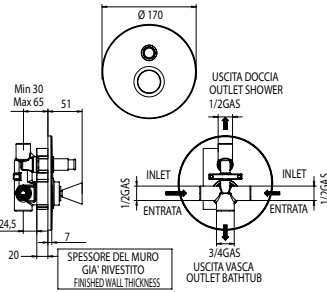

| €uro | art. |
|--------|------------|
| 210,00 | 9546200000 |
| 235,00 | 9546200001 |

G 1/2"
 G 1/2"
 G 1/2"
 G 3/4"
 383885
 383895 JOYSTICK
 INOX
 16 l/min.

Parte grezza incassata per monocomando vasca/doccia incasso

Rough part built-in, for concealed single lever bath shower
UP rohes Teil für Wanne/Dusche
Lado basto encajonado para monomando banera/ducha de pared
Partie brute encastree pour mitigeur baignoire/douche à encastrer



| €uro | art. |
|--------|--------|
| 152,00 | 387064 |

G 1/2"
 G 1/2"
 G 1/2"
 G 3/4"
 383885
 INOX

Parte grezza incassata per monocomando vasca/doccia incasso

Rough part built-in, for concealed single lever bath shower
UP rohes Teil für Wanne/Dusche
Lado basto encajonado para monomando banera/ducha de pared
Partie brute encastree pour mitigeur baignoire/douche à encastrer



| €uro | art. |
|--------|--------|
| 152,00 | 387454 |

G 1/2"
 G 1/2"
 G 1/2"
 G 3/4"
 383885
 INOX

Parte esterna incasso vasca/doccia (leva conica)

Outside part of concealed bathtub/shower (conical lever)
Außen Teil für Wanne/Dusche (konischer Hebel)
Lado exterior de pared banera/ducha (palanca cónica)
Partie externe pour douche/baignoire à encastrer (levier conique)



| €uro | art. |
|-------|--------|
| 99.00 | 387154 |

PYRAMIDE



0003000000
0009000000
Leva conica
Conical lever
Konischer Hebel
Palanca cónica
Levier conique



0001000000
0008000000
Leva joystick
Joystick lever
Joystick-Bedienhebel
Palanca joystick
Levier joystick

| | | | | |
|---|--|--|--|--|
| OO Cromo Chrome Chrom Cromo Chrome | | | | |
|---|--|--|--|--|

416



Parte esterna incasso vasca/doccia (Leva joystick)

Outside part of concealed bathtub/shower (joystick lever)
Außen Teil für Wanne/Dusche (Joystick-Bedienhebel)
Lado exterior de pared banera/ducha (palanca joystick)
Partie externe pour douche/baignoire à encastrer (levier joystick)

| art. | €uro | | | |
|--------|--------|--|--|--|
| 387444 | 123,00 | | | |
| | | | | |
| | | | | |



Monocomando doccia incasso con presa acqua

Concealed single-lever shower control with water supply attachment
Brauseeinhebelmischer-UP mit Wandanschlußbogen
Monomando ducha, de pared con empalme agua
Mitigeur de douche à encastrer avec prise d'eau

| art. | €uro | | | |
|------------|--------|--|--|--|
| 9549200000 | 282,00 | | | |
| 9548200000 | 317,00 | | | |
| | | | | |

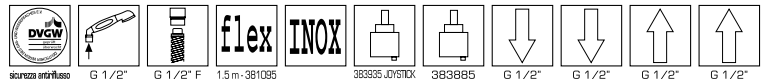

PYRAMIDE

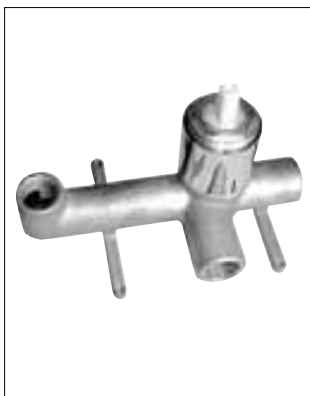

Parte grezza incassata per monocomando incasso doccia

Rough part built-in for concealed single lever shower mixer
UP rohes Teil für Dusche ehm
Lado basto encajonado para monomando ducha de pared
Partie brute encastree pour mitigeur de douche à encastrer

| art. | €uro | | | |
|--------|--------|--|--|--|
| 387944 | 145,00 | | | |
| | | | | |
| | | | | |

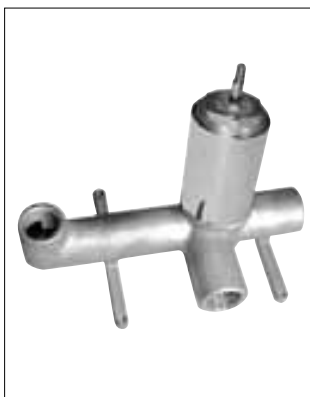
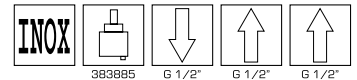

Parte grezza incassata per monocomando incasso doccia

Rough part built-in for concealed single lever shower mixer
UP rohes Teil für Dusche ehm
Lado basto encajonado para monomando ducha de pared
Partie brute encastree pour mitigeur de douche à encastrer

| art. | €uro | | | |
|--------|--------|--|--|--|
| 388944 | 145,00 | | | |
| | | | | |
| | | | | |

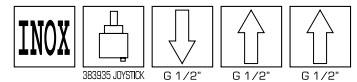

| | | | |
|---|--|--|--|
| OO Cromo Chrome Chrom Cromo Chrome | | | |
|---|--|--|--|

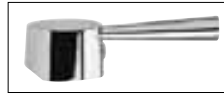

0003000000
0009000000
Leva conica
Conical lever
Konischer Hebel
Palanca cónica
Lever conique



0001000000
0008000000
Leva joystick
Joystick lever
Joystick-Bedienhebel
Palanca joystick
Lever joystick

Parte esterna incasso doccia (leva cilindrica)

Outside part of concealed shower (cylindrical lever)
Außen Teil für Dusche (zylindrischer Hebel)
Lado exterior de pared ducha (palanca cilíndrica)
Partie externe pour douche à encastrer (levier cylindrique)

| Euro | | | | art. |
|--------|--|--|--|--------|
| 170,00 | | | | 388954 |
| | | | | |
| | | | | |

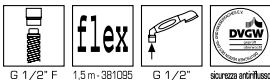

Parte esterna incasso doccia (Leva joystick)

Outside part of concealed shower (joystick lever)
Außen Teil für Dusche (Joystick-Bedienhebel)
Lado exterior de pared ducha (palanca joystick)
Partie externe pour douche à encastrer (levier joystick)

| Euro | | | | art. |
|--------|--|--|--|--------|
| 192,00 | | | | 388964 |
| | | | | |
| | | | | |

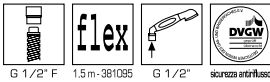

Monocomando doccia esterno completo

Single-lever wall mtd shower set
Brauseeinhebelmischer mit Handbrause und Brausehalter
Monomando ducha externo completo
Mitigeur de douche externe complet

| Euro | | | | art. |
|--------|--|--|--|------------|
| 284,00 | | | | 9583200000 |
| 296,00 | | | | 9581200000 |
| | | | | |
| | | | | |

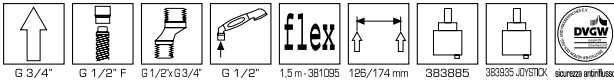
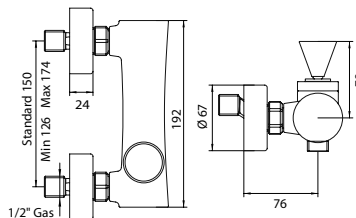

Monocomando doccia esterno senza kit doccia

Single-lever wall mtd shower set without shower kit
Brauseeinhebelmischer ohne Duschset
Monomando ducha externo sin kit de ducha
Mitigeur de douche externe sans kit de douche

| Euro | | | | art. |
|--------|--|--|--|-------------|
| 224,00 | | | | 95832000SF |
| 236,00 | | | | 958A12000SF |
| | | | | |
| | | | | |

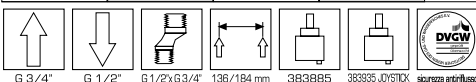
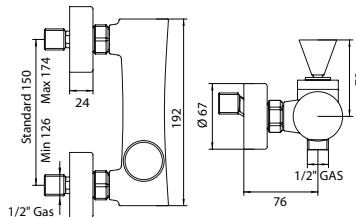

PYRAMIDE



0003000000
0009000000
Leva conica
Conical lever
Konischer Hebel
Palanca cónica
Levier conique



0001000000
0008000000
Leva joystick
Joystick lever
Joystick-Bedienhebel
Palanca joystick
Levier joystick

| | | | |
|---|--|--|--|
| OO Cromo Chrome Chrom Cromo Chromé | | | |
|---|--|--|--|

418

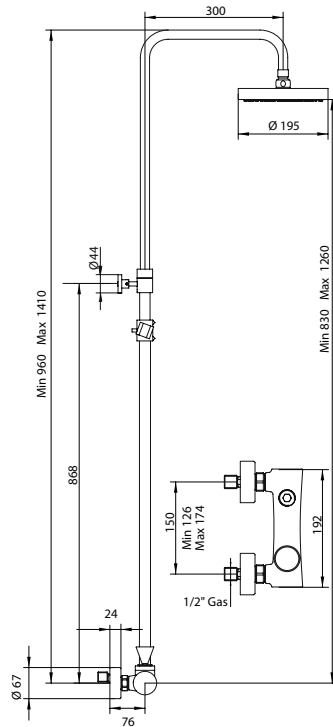
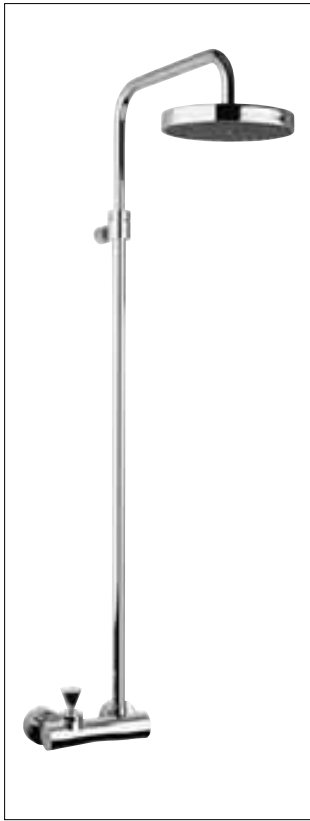

Monocomando doccia esterno con soffione

Single-lever wall mtd shower set with shower head
Brauseeinhebelsmischer-Wellness, mit Kopfbrause
Monomando ducha externo con alcachofa
Mitigeur de douche externe avec pommeau

| art. | Euro | | |
|------------|--------|--|--|
| 9533200000 | 582,00 | | |
| 9531200000 | 594,00 | | |

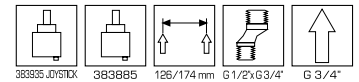

PYRAMIDE

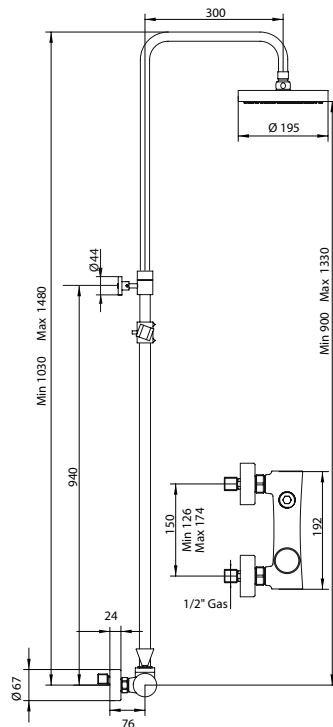
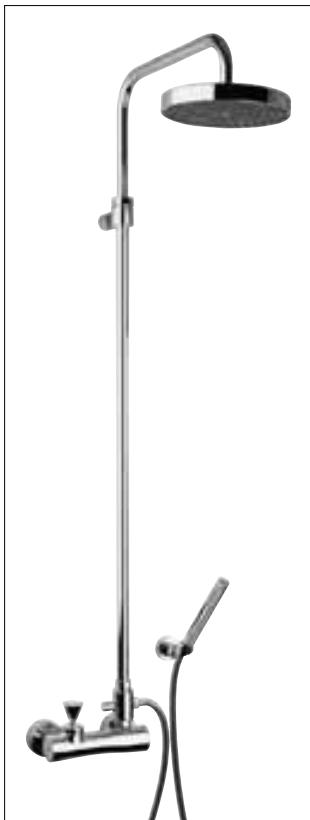

Monocomando doccia esterno con soffione e doccetta

Single-lever wall mtd shower set with shower head and handshower
Brauseeinhebelsmischer-Wellness, mit Kopf und Handbrause
Monomando ducha externo con alcachofa y teléfono
Mitigeur de douche externe avec pommeau et douchette

| art. | Euro | | |
|------------|--------|--|--|
| 9593200000 | 673,00 | | |
| 9591200000 | 685,00 | | |



| | | | |
|---|--|--|--|
| OO Cromo Chrome Chrom Cromo Chrome | | | |
|---|--|--|--|



0003000000
0009000000
Leva conica
Conical lever
Konischer Hebel
Palanca cónica
Levier conique



0001000000
0008000000
Leva joystick
Joystick lever
Joystick-Bedienhebel
Palanca joystick
Levier joystick

Monocomando doccia esterno senza braccio e kit doccia

Single-lever wall mtd shower set without arm or shower kit
Brauseeinhebelsmischer-Wellness ohne Duschset
Monomando ducha externo sin brazo y kit de ducha
Mitigeur de douche externe sans bras et kit de douche

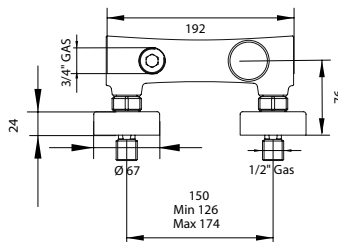

| €uro | art. |
|--------|------------|
| 224,00 | 95932000SF |
| 236,00 | 95912000SF |

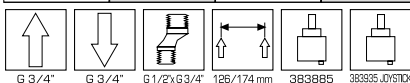

Monocomando lavello

Single-lever sink mixer
Spültischeinhebelsmischer
Monomando fregadero
Mitigeur d'évier

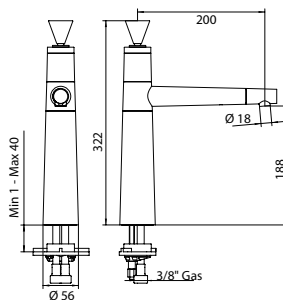

| €uro | art. |
|--------|------------|
| 296,00 | 9573200000 |
| 315,00 | 9571200000 |

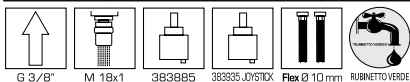

Doccetta anticalcare 1 getto con asta saliscendi e presa acqua

Anti-limescale handshower, 1-jet, with slide bar and water supply attachment
Brausegarnitur, 1-Strahl-Antikalk-Handbrause
Teléfono ducha 1 chorro anti-cal con barra deslizante y empalme agua
Douchette 1 jet anti-calcaire avec tige télescopique et prise d'eau

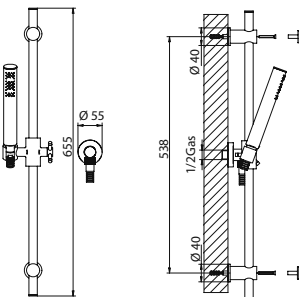

| €uro | art. |
|--------|------------|
| 170,00 | 7470200000 |

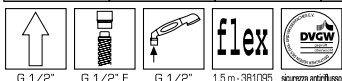

Asta saliscendi

Slide bar
Brausegestänge
Barra deslizante
Tige télescopique

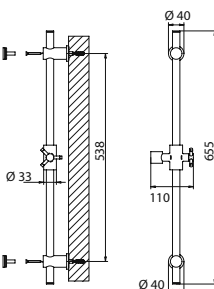

| €uro | art. |
|--------|--------|
| 128,00 | 391776 |

PYRAMIDE

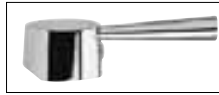

0003000000
0009000000
Leva conica
Conical lever
Konischer Hebel
Palanca cónica
Levier conique



0001000000
0008000000
Leva joystick
Joystick lever
Joystick-Bedienhebel
Palanca joystick
Levier joystick

| | | | |
|---|--|--|--|
| OO Cromo Chrome Chrom Cromo Chromé | | | |
|---|--|--|--|

420

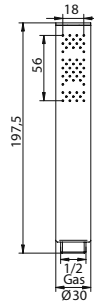

Doccetta anticalcare 1 getto

Anti-limescale handshower, 1-jet
Handbrause-1-Strahl-Antikalk
Teléfono ducha 1 chorro anti-cal
Douchette 1 jet anti-calcaire

| art. | €uro | | |
|--------|-------|--|--|
| 386144 | 25,00 | | |
| | | | |
| | | | |

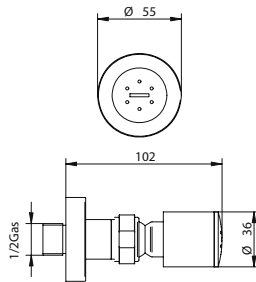

Soffione doccia laterale 1/2"

Lateral shower head 1/2"
Seitenbrause 1/2"
Lateral alcachofa de ducha 1/2"
Pomme de douche latéral 1/2"

| art. | €uro | | |
|--------|-------|--|--|
| 386294 | 90,00 | | |
| | | | |
| | | | |



PYRAMIDE

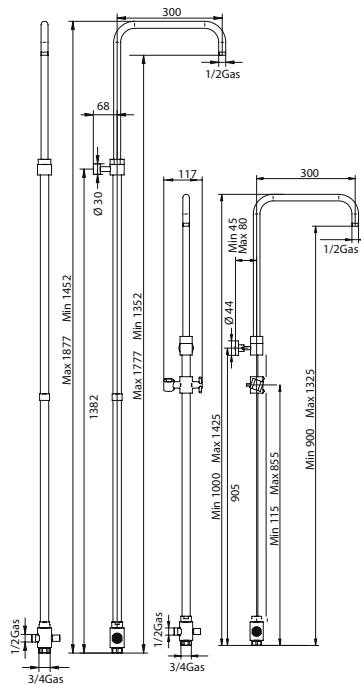

Asta doccia con deviatore

Shower arm with diverter
Brausearm mit Umsteller
Barra de ducha con desviador
Tige de douche avec inverseur

| art. | €uro | | |
|-------------|--------|--|--|
| 385644 L130 | 260,00 | | |
| 385654 L170 | 290,00 | | |
| | | | |
| | | | |

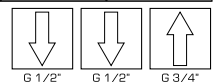

OO
Cromo
Chrome
Chrom
Cromo
Chrome

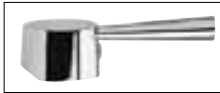

0003000000
0009000000
Leva conica
Conical lever
Konischer Hebel
Palanca cónica
Levier conique



0001000000
0008000000
Leva joystick
Joystick lever
Joystick-Bedienhebel
Palanca joystick
Levier joystick

Asta doccia senza deviatore

Shower arm without diverter
Brausearm ohne Umsteller
Barra de ducha sin desviador
Tige de douche sans inverseur

| Euro | | art. | |
|--------|--|------|---------------|
| 230,00 | | L130 | 375534 |
| 260,00 | | L170 | 375294 |
| | | | |
| | | | |

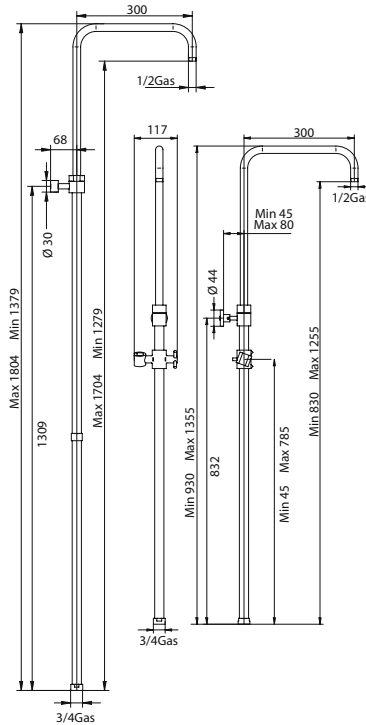
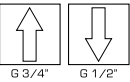

Deviatore per asta doccia

Shower arm diverter
Umsteller für Brausearm
Desviador para barra de ducha
Inverseur pour tige de douche

| Euro | | art. | |
|-------|--|------|---------------|
| 30,00 | | | 386044 |
| | | | |
| | | | |

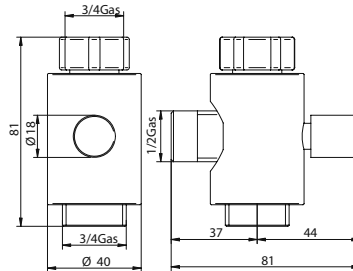
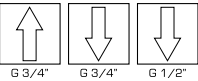

PYRAMIDE

Presca acqua per asta doccia 1/2"x3/4"

Shower arm water supply attachment 1/2"x3/4"
Wandanschlußbogen für Brausearm 1/2"x3/4"
Empalme agua para barra de ducha 1/2"x3/4"
Prise d'eau pour tige de douche 1/2"x3/4"

| Euro | | art. | |
|-------|--|------|-------------------|
| 70,00 | | | 6497200030 |
| | | | |
| | | | |

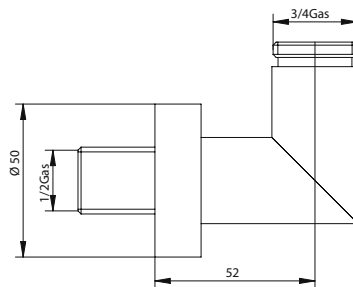
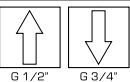



0013000000
0019000000
Leva conica
Conical lever
Konischer Hebel
Palanca cónica
Levier conique



0001000000
0008000000
Leva joystick
Joystick lever
Joystick-Bedienhebel
Palanca joystick
Levier joystick

| | | | | |
|---|--|--|--|--|
| OO Cromo Chrome Chrom Cromo Chromé | | | | |
|---|--|--|--|--|

422

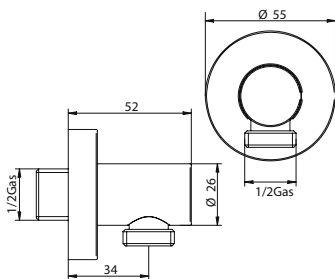

Preso acqua
Water supply attachment
Wandanschlußbogen
Empalme agua
Prise d'eau

| art. | €uro | | | |
|-------|-------|--|--|--|
| 90934 | 22,00 | | | |
| | | | | |
| | | | | |

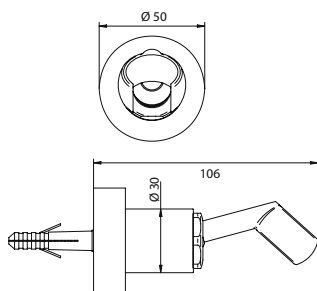
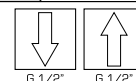

Attacco a snodo per doccia
Swivel wall bracket for handshower
Brausehalter
Soporte para teléfono ducha articulado
Raccord de douchette articulé

| art. | €uro | | | |
|--------|-------|--|--|--|
| 384060 | 22,00 | | | |
| | | | | |
| | | | | |

PYRAMIDE

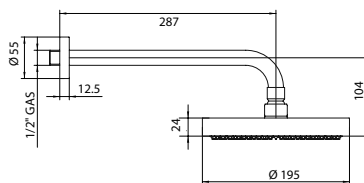

Braccio doccia con soffione anticalcare
Shower arm, anti-limescale shower head
Arm und Antikalk Kopfbrause
Alcachofa de ducha anti-cal con brazo
Bras de douche avec pommeau anti-calcaire

| art. | €uro | | | |
|------------|--------|--|--|--|
| 6471000000 | 220,00 | | | |
| | | | | |
| | | | | |

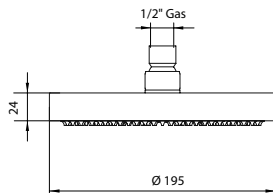

Soffione con anticalcare
Anti-limescale shower head
Antikalk Kopfbrause
Alcachofa de ducha anti-cal
Pomme de douché anti-calcaire

| art. | €uro | | | |
|--------|--------|--|--|--|
| 386194 | 190,00 | | | |
| | | | | |
| | | | | |



OO
Cromo
Chrome
Chrom
Cromo
Chrome

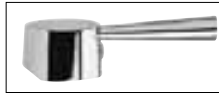

000300000
000900000
Leva conica
Conical lever
Konischer Hebel
Palanca cónica
Levier conique



000100000
000800000
Leva joystick
Joystick lever
Joystick-Bedienhebel
Palanca joystick
Levier joystick

Braccio doccia

Shower arm
Kopfbrausearm
Alcachofa de ducha con brazo
Bras de douche

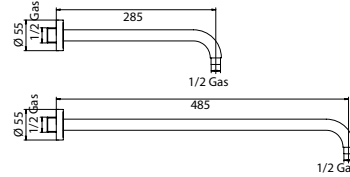

| Euro | art. |
|-------|--------------------|
| 30,00 | L300 100234 |
| 40,00 | L500 100044 |

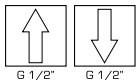

Braccio doccia da soffitto

Ceiling shower arm
Deckenanschluß für Kopfbrause
Alcachofa de ducha con brazo para techo
Bras de douche plafonnier

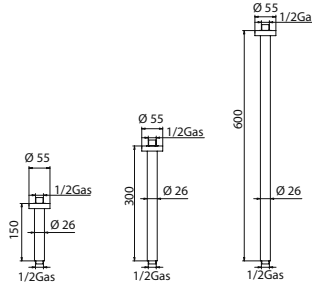

| Euro | art. |
|-------|---------------------|
| 40,00 | 15 CM 385984 |
| 49,00 | 30 CM 385414 |
| 78,00 | 60 CM 385974 |

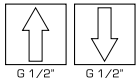

Attacco per gruppo su bordo vasca

Pillar union
Wannenrandstützrohrpaar, 3/4"-Konusaufnahme
Soporte para teléfono ducha grupo repisa bañera
Raccord pour groupe sur bord de baignoire

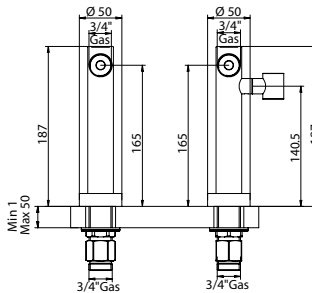

| Euro | art. |
|--------|-------------------|
| 170,00 | 5191200030 |

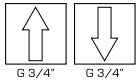

Coppia colonne da terra per vasca esterna

Pair of columns for bathtub group
Standrohrpaar für freistehende Badewanne, 3/4"-Konusaufnahme
Pareja columnas bañera externas, para encastre en pavimento
Couple de colonnes externe pour baignoire

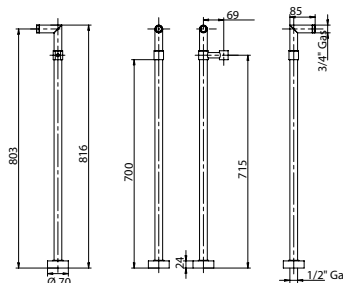

| Euro | art. |
|--------|-------------------|
| 340,00 | 5181200030 |

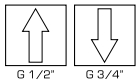

PYRAMIDE



0003000000
0009000000
Leva conica
Conical lever
Konischer Hebel
Palanca cónica
Levier conique



0001000000
0008000000
Leva joystick
Joystick lever
Joystick-Bedienhebel
Palanca joystick
Levier joystick

| | | | | |
|---|--|--|--|--|
| OO Cromo Chrome Chrom Cromo Chromè | | | | |
|---|--|--|--|--|

424

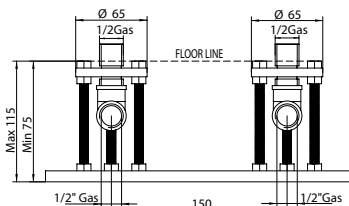

Piastra di fissaggio per colonna vasca

Fixing plate for bathtub columns
Platte zur Befestigung der Badewanne Säulen
Lamina por fijar la columnas de la bañera
Plaque de fixation pour colonne de baignoire

| art. | €uro | | | |
|------------|--------|--|--|--|
| 5192200000 | 135,00 | | | |
| | | | | |
| | | | | |

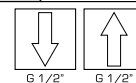

Flessibile doppia aggraffatura, F 1/2"x F 1/2"- 1,50 m

Reinforced flex hose, F 1/2"x F 1/2" - 1,50 m
Brauseschlauch F 1/2"x F 1/2"x 1,50 m
Flexible con doble engrapado, F 1/2"x F 1/2" - 1,50 m
Flexible double agrafage, F 1/2"x F 1/2" - 1,50 m

| art. | €uro | | | |
|--------|-------|--|--|--|
| 381095 | 18,00 | | | |
| | | | | |
| | | | | |

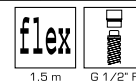

PYRAMIDE



Leva joystick
Joystick lever
Joystick-Bedienhebel
Palanca joystick
Levier joystick

| art. | €uro | | | |
|-------|-------|--|--|--|
| 11224 | 40,00 | | | |
| | | | | |
| | | | | |



Leva conica
Conical lever
Konischer Hebel
Palanca cónica
Levier conique

| art. | €uro | | | |
|--------|-------|--|--|--|
| 375834 | 35,00 | | | |
| | | | | |
| | | | | |

Note:
La Bandini consiglia l'installazione di rubinetti filtro ispezionabili sulle due mandate per trattenere eventuali corpi estranei che potrebbero danneggiare gli organi di tenuta.

Note:
Bandini advises installation of filters that can be inspected on both delivery circuits so as to trap foreign bodies that might damage seals/gaskets etc.

Empfehlung:
Bandini empfiehlt den Einbau von Eckventilen mit Filter, als Schutzmaß die Dichtungen und Kartusche beschädigen könnten gegen Fremdkörpern

Notas:
Bandini aconseja la instalación de grifos filtro inspeccionables de las dos descargas para retener eventuales cuerpos extraños que podrían dañar los elementos de estanqueidad.

Remarque:
Bandini recommande l'installation de robinets disposant de filtres démontables sur les deux sorties afin de retenir d'éventuels corps étrangers qui pourraient nuire à l'étanchéité.

La Bandini si riserva in diritto, ogni qualvolta si rendesse necessario, di apportare modifiche tecniche ed estetiche senza obbligo di preavviso.

Bandini reserves the right, whenever necessary, to make technical and aesthetic modifications without prior warning.

Bandini hat das Recht sich aestetische und technische Änderungen vorzunehmen wo sie nötig sind ohne vorzeitig zu informieren.

La Bandini se reserva el derecho, cada vez que fuese necesario, de aportar modificaciones técnicas y estéticas sin obligación de previo aviso.

Bandini se réserve le droit, chaque fois que cela est nécessaire, d'apporter des modifications techniques et esthétiques sans obligation de préavis.



| | |
|---------------|--------------|
| art. | €uro |
| 383935 | 20,00 |

Cartuccia ceramica joystick

CARATTERISTICHE TECNICHE

- Orbitazione leva attorno l'asse centrale: 12,5° in tutte le direzioni
- Corsa piastrine in apertura: 5 mm
- Tenuta a pressioni statiche: superiore a 30 bar
- Cicli: 300.000
- Rumore max: 18 db. A
- Shock termici: da 1° a 100° C
- Portata max a 3 bar senza resistenza: 33 l/min.

Joystick ceramic cartridge

TECHNICAL CHARACTERISTICS

- Lever orbiting around main axis: 12,5° in all directions.
- Ceramic disk travel on opening: 5 mm
- Sealing at static pressures: over 30 bar.
- Cycles: 300,000
- Max noise: 18 dbA
- Thermal shock: from 1° to 100° C
- Max flow rate at 3 bar without resistance: 33 l/min.

Joystick Keramikkartusche

TECHNISCHE ANGABEN

- Hebel, der die Haupt Achse umkreist, 12,5° in allen Richtungen.
- Keramische Diskettenreibung auf dem Öffnen: 5 mm
- Das Bersten bei statischem Druck: über 30 bar.
- Zyklen: 300.000
- Max. Geräusche: 18 dbA
- Thermischer Schock: von 1° bis 100° C
- Max. Strömungsrate bei 3 bar ohne Widerstand: 33 l/min.

Cartucho cerámico joystick

CARACTERÍSTICAS TÉCNICAS

- Rotación manecilla alrededor del eje central: 12,5° en todas las direcciones
- Carrera placas en apertura: 5 mm
- Resistencia a presiones estáticas: superior a 30 bares
- ciclos: 300.000
- Ruido máx.: 18 db. A
- Shock Térmicos: de 1° a 100°
- Capacidad máx. a 3 bares sin resistencia: 33 l/min.

Cartouche céramique joystick

CARACTÉRISTIQUES TECHNIQUES

- Rotation du levier autour de l'axe central: 12,5° dans les deux directions
- Course de la plaquette en ouverture: supérieure à 30 bars
- Cycles : 300.000
- Niveau de bruit max. : 18 dbA
- Chocs thermiques : de 1° à 100° C
- Débit max. à 3 bars sans résistance : 33 l/min

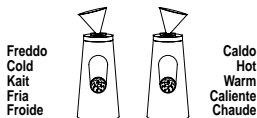

In questa collezione la cartuccia sferica di nuova generazione utilizzata prevede l'erogazione dell'acqua calda azionando la leva di comando miscelazione verso DESTRA e quella dell'acqua fredda verso SINISTRA.

This collection is provided with a spherical cartridge that supplies hot water by pushing the lever to the RIGHT and cold water to the LEFT.

Diese Kollektion ist mit einer kugelförmigen Kartusche aus-gestattet, die beim Betätigen des Hebels nach links, die Armatur mit Kaltwasser bzw nach rechts, mit Warmwasser versorgt.

Esta colección se suministra con cartucho esférico que hace que salga agua caliente empujando la manecilla hacia la DERECHA y agua fría hacia la IZQUIERDA.

Cette collection prévoit une cartouche sphérique qui débite l'eau chaude en poussant le levier vers DROIT et l'eau froide vers GAUCHE.

| | |
|---------------|--------------|
| art. | €uro |
| 383885 | 20,00 |

Cartuccia ceramica comando a leva

CARATTERISTICHE TECNICHE

- Cartucce di tipo chiuso
- Diametro 35 mm
- Rotazione leva di apertura 25°
- Rotazione leva di miscelazione 110°
- Corsa piastrine 5 mm
- Tenuta a pressione statiche 30 bar
- Tenuta a colpi d'ariete fino a 50 bar
- Shock termici da 5° C a 90° C max supportabile
- Antirumore con retino
- Portata libera oltre i 30 litri
- Rumore e portata rispettano ampiamente tutte le normative vigenti nei paesi europei

Ceramic cartridge lever command

TECHNICAL SPECIFICATIONS

- Closed-cartridge
- 35 mm diameter
- Opening lever rotation 25°
- Mixing lever rotation 110°
- Ceramic disk travel on opening: 5 mm
- Seal at static pressure at 30 bar
- Seal at water hammer up to 50 bar
- Thermal shock from 5° C to 90° C
- Anti-noise system
- Free flow rate over 30 litres
- Noise levels and flow rates comply with all European standards

Keramikkartusche

TECHNISCHE ANGABEN

- Geschlossene Kartusche
- 35 mm Durchmesser
- Öffnung Rotation des Hebels 25°
- Mischstellung des Hebels 110°
- Keramische Dichtscheibe 5 mm
- Abdichtung bei statischem Druck von 30 bar
- Abdichtung bei unterbrochenen Wasserdruck bis 50 bar
- Thermischer Schock von 5° C bis zu 90° C
- Anti Geräusch System
- Freier Auslauf über 30 Liter
- Geräusch und Wasserflussnormen folgen die europäischen geltende Bestimmungen.

Cartucho cerámico accionamiento mediante manecilla

CARACTERÍSTICAS TÉCNICAS

- Cartuchos de tipo cerrado
- Diámetro 35 mm.
- Rotación manecilla de apertura 25°
- Rotación manecilla de mezclado 110°
- Carrera placas 5 mm.
- Resistencia a presiones estáticas 30 bares
- Resistencia a golpes de ariete hasta 50 bares
- Shock térmicos de 5° C a 90° C máx. que puede soportar
- Anti-ruido con red
- Caudal libre más allá de los 30 litros
- Ruido y caudal respetan ampliamente todas las normativas vigentes en los países europeos.

Cartouche en céramique, commande à levier

CARACTÉRISTIQUES TECHNIQUES

- Cartouche de type fermé
- Diamètre 35 mm
- Rotation du levier d'ouverture 25°
- Rotation du levier de mélange 110°
- Course de la plaquette 5 mm
- Etanchéité à pression statique 30 bars
- Etanchéité à coup de bélier jusqu'à 50 bars
- Chocs thermiques : de 5° à 90° C
- Silencieux avec fillet
- Débit libre au-dessus de 30 litres
- Les niveaux de bruit et de débit sont en conformité avec toutes les normes en vigueur dans les pays européens.

426